

## City of Mandurah Facility Information Guide

# Lakelands Community House

Corner Dalona Parkway and Jasper Way Lakelands

### General Description

- Lakelands Community House is a contemporary residential house that has been adapted for shared use by local residents and Peet Ltd land sales office.
- The house has a spacious open plan family room (pictured) ideal for large group functions or meetings.
- Also there is a small meeting room which houses Lakelands Pocket Library. It can be used for reading or for meetings.
- A well equipped modern kitchen is great for cooking or just making morning or afternoon tea.
- The backyard is beautifully landscaped with a decked cabana and a large sandpit which is an ideal play area for young children
- The house is suitable for many activities including formal and informal meetings, playgroup, arts and craft activities and cooking.



### General Information No smoking /Disabled access

<b>Capacity</b>	40 - 50
<b>Security</b>	Monitored Alarm
<b>Temperature Control</b>	Air Conditioning
<b>Safety</b>	Fire extinguishers, blankets and smoke alarm
<b>Toilets</b>	Unisex disabled
<b>Cleaning Equipment</b>	In kitchen
<b>Electricity</b>	Power points in meeting rooms and kitchen
<b>Parking Bays</b>	Shared parking with Display Village 1 disabled
<b>Meeting Room 1</b>	50 square metres – 10 lounge chairs 2 tables. Capacity 25
<b>Meeting Room 2 – Pocket Library</b>	6 chairs 1 large table. Capacity 8-10 Whiteboard available – phone Kelly on 9550 3620 for details
<b>Kitchen</b>	
Stove	1 large gas cooker with oven
Fridge	1 Fridge/freezer
Kettle	1 Standard household jug
Bins	1 kitchen bin
Cupboards	1 pantry and several cupboards
Other	1 microwave / 1 Toaster
<b>Entertainment</b>	1 TV/ DVD player/ Stereo

### Booking

If you wish to hire this facility please contact Kelly Harrington at Recreation Services on (08) 9550 3620 or email [recreationervices@mandurah.wa.gov.au](mailto:recreationervices@mandurah.wa.gov.au)

Library Open Times – The Library is open at the same times as the Land Sales Office:

Mon & Tues 2pm - 5pm, Wednesday 3.30pm - 5pm, and Sat & Sun 1pm – 5pm

### Directions

From Mandurah travel north on Mandurah Road, go straight ahead through Meadow Springs lights and Lord Hobart drive lights. Take the next right into Catalina Drive, first left into Jasper Way and the Community House is on the corner of Jasper Way and Dalona Parkway. Entry is via the front entrance next to Peet Ltd land sales office.

# Lakelands Community House – Facility Plan

NB The shaded zones of the house are for private and / or authorised use only

**F** Location of Fire Extinguishers

## COHEN VISTA

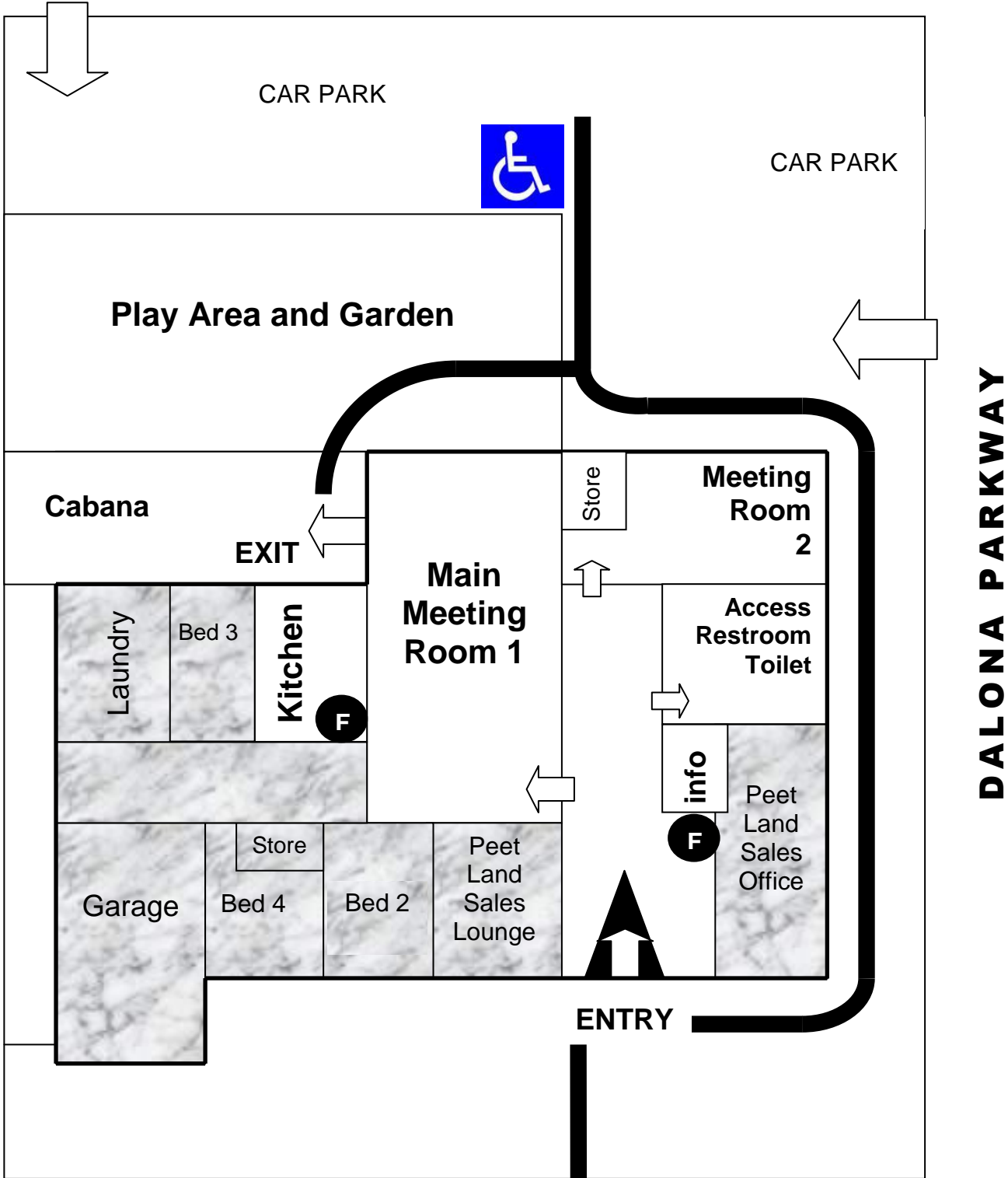

## JASPER WAY